

* : TOLERANCE BETWEEN DOWELS $\pm 0,02$, BETWEEN SCREW HOLES $\pm 0,1$
 ** : AREA TO ACCESS ANGLE ADJUSTMENT
 *** : DIMENSIONS TO BE RESPECTED IN CASE OTHER MANUAL LEVERS ARE USED

Bore \varnothing	Holding moment	Clamping moment (0,5 MPa)	Weight (clamping arm not included)
40 mm	600 Nm	170 Nm	2,1 Kg

Min./Max. operating pressure: **0,4 / 0,6 MPa**
 Operating temperature: **5° ÷ 45° C**
 Opening angle: **adjustable**
 Without arm
 Electronic sensor with M12 swivel connector, from 0° to 90°
 Supply voltage: 10 ÷ 30 Vdc
 IP code: **IP 65**
 Pneumatic ports on both sides

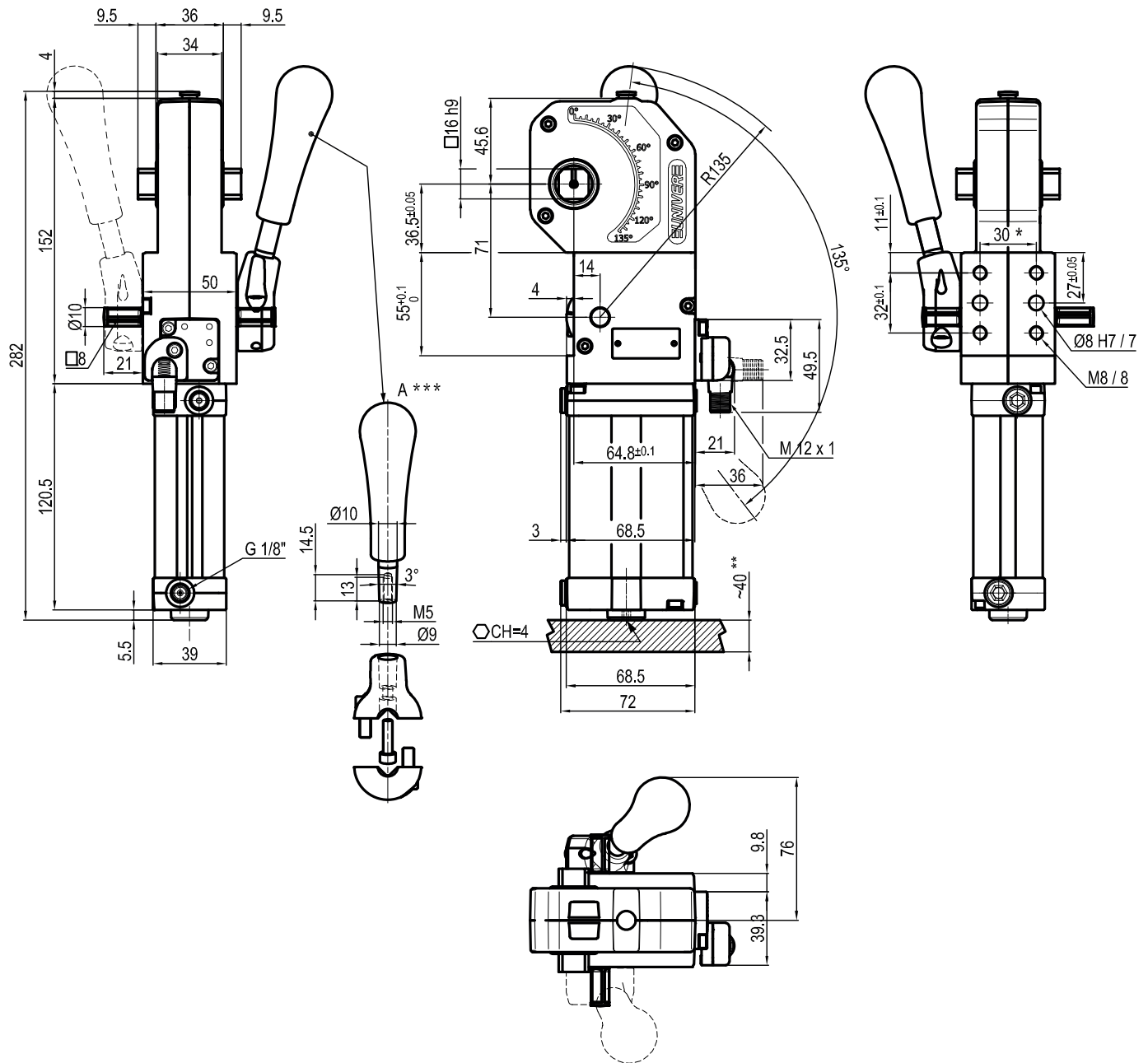

* : TOLERANCE BETWEEN DOWELS $\pm 0,02$, BETWEEN SCREW HOLES $\pm 0,1$
 ** : AREA TO ACCESS ANGLE ADJUSTMENT
 *** : DIMENSIONS TO BE RESPECTED IN CASE OTHER MANUAL LEVERS ARE USED

Bore \varnothing	Holding moment	Clamping moment (0,5 MPa)	Weight (clamping arm not included)
40 mm	600 Nm	170 Nm	2,1 Kg

Min./Max. operating pressure: **0,4 / 0,6 MPa**
 Operating temperature: **5° ÷ 45° C**
 Opening angle: **adjustable**
 Without arm
 Electronic sensor with M12 swivel connector, from 0° to 90°
 Supply voltage: 10 ÷ 30 Vdc
 IP code: **IP 65**
 Pneumatic ports on both sides

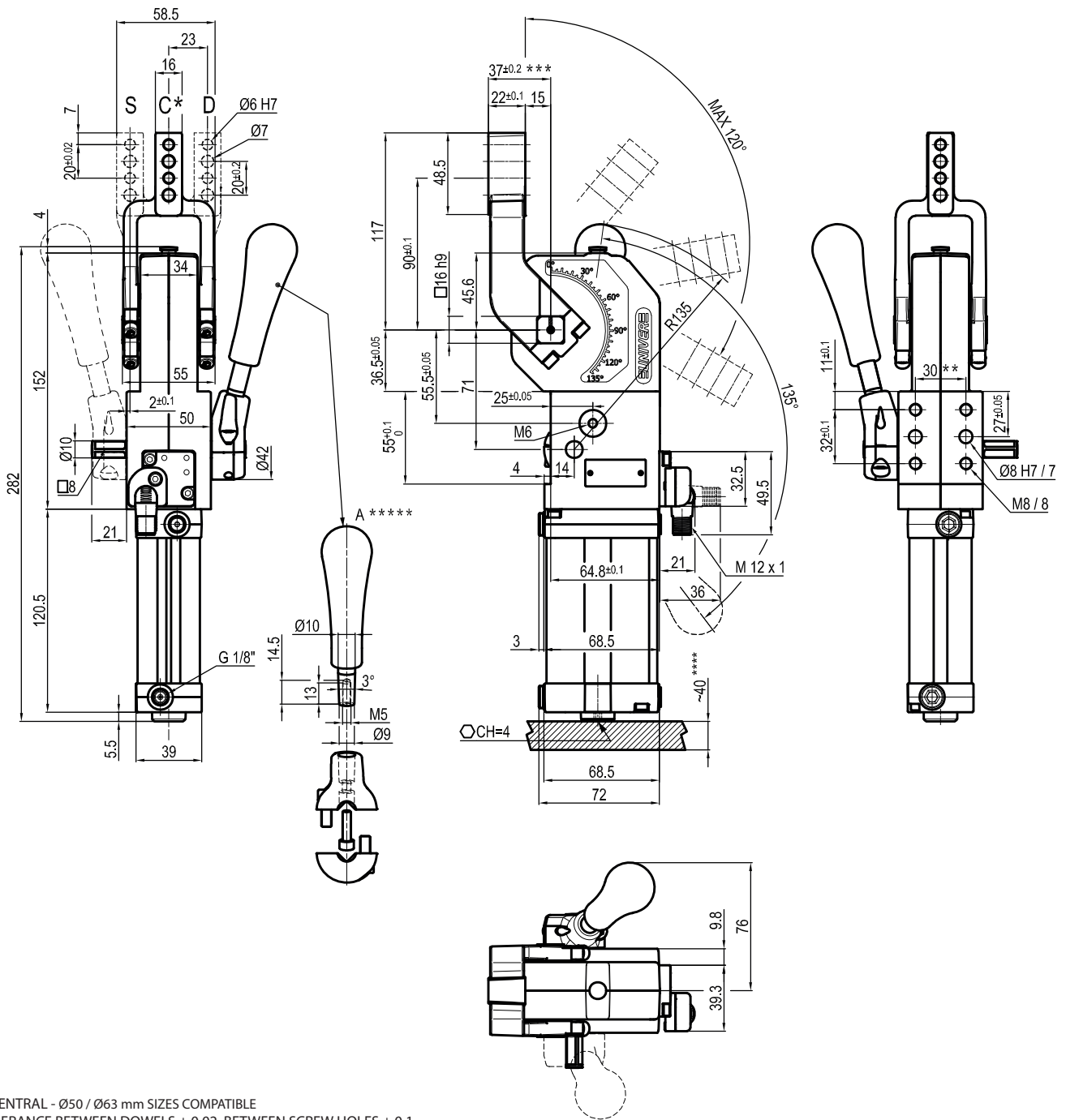

* : "E" CENTRAL - Ø50 / Ø63 mm SIZES COMPATIBLE
 ** : TOLERANCE BETWEEN DOWELS ± 0,02, BETWEEN SCREW HOLES ± 0,1
 *** : TOLERANCE AT 80 mm FROM PIVOT POINT
 ***** : AREA TO ACCESS ANGLE ADJUSTMENT

UCIM400 __ AK0

6 7
6 ARM STYLE

C = Central
 D = Right
 S = Left

7 ARM TYPE

A = Aluminium
 S = Steel

Bore Ø	Holding moment	Clamping moment (0,5 MPa)	Weight (clamping arm not included)
40 mm	600 Nm	170 Nm	2,1 Kg

Min./Max. operating pressure: **0,4 / 0,6 MPa**
 Operating temperature: **5° ÷ 45° C**
 Opening angle: **adjustable from 0° to 120°**
 Arm position: **180°**
 With manual lever
 Electronic sensor with M12 swivel connector, from 0° to 90°
 Supply voltage: **10 ÷ 30 Vdc**
 IP code: **IP 65**
 Pneumatic ports on both sides

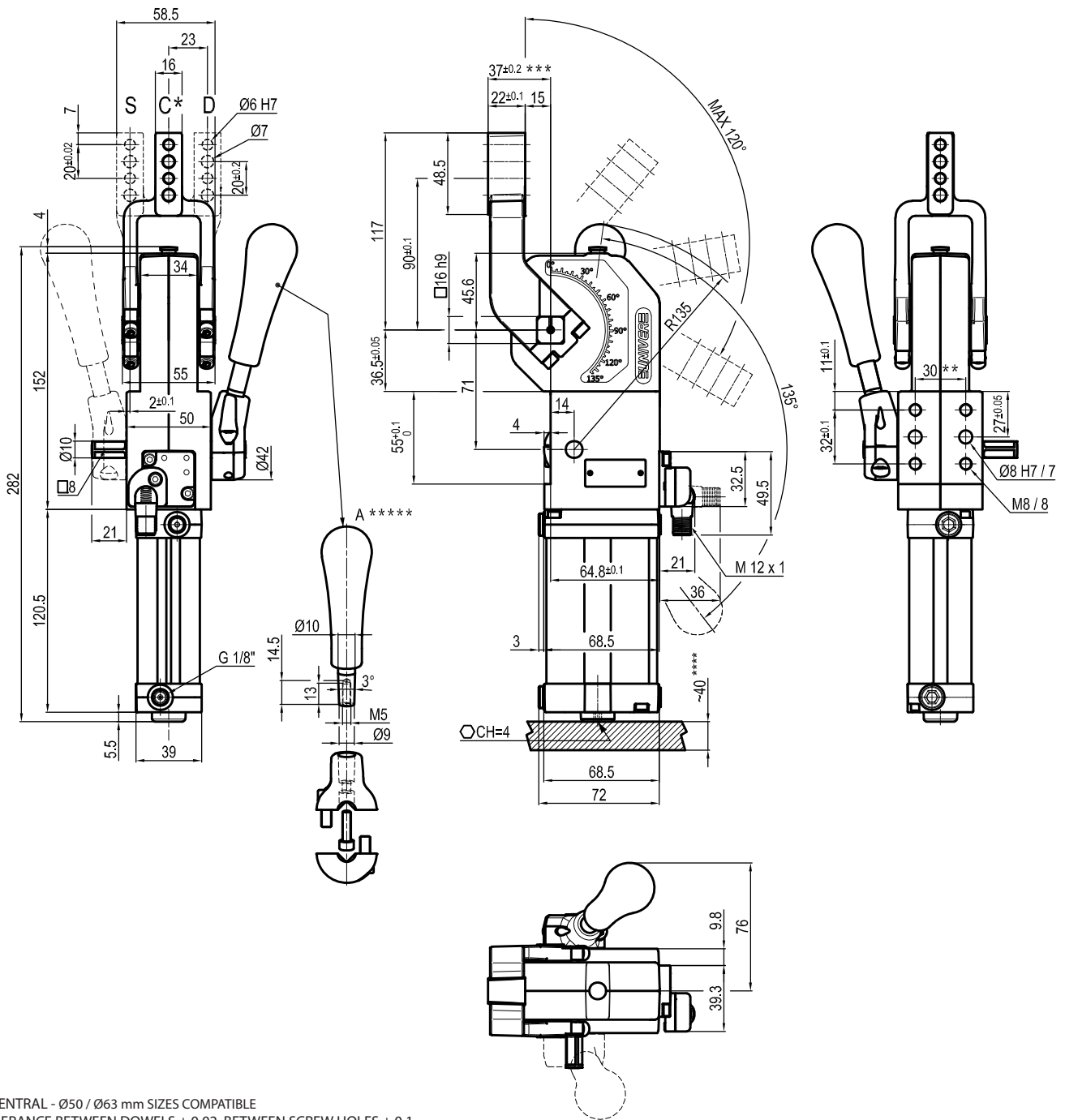

* : "E" CENTRAL - Ø50 / Ø63 mm SIZES COMPATIBLE
 ** : TOLERANCE BETWEEN DOWELS ± 0,02, BETWEEN SCREW HOLES ± 0,1
 *** : TOLERANCE AT 80 mm FROM PIVOT POINT
 **** : AREA TO ACCESS ANGLE ADJUSTMENT

UCIM400 __ NK0
6 ARM STYLE

7 ARM TYPE

6 7

C = Central
 D = Right
 S = Left

A = Aluminium
 S = Steel

Bore Ø	Holding moment	Clamping moment (0,5 MPa)	Weight (clamping arm not included)
40 mm	600 Nm	170 Nm	2,1 Kg

Min./Max. operating pressure: **0,4 / 0,6 MPa**
 Operating temperature: **5° ÷ 45° C**
 Opening angle: **adjustable from 0° to 120°**
 Arm position: **180°**
 With manual lever
 Electronic sensor with M12 swivel connector, from 0° to 90°
 Supply voltage: **10 ÷ 30 Vdc**
 IP code: **IP 65**
 Pneumatic ports on both sides

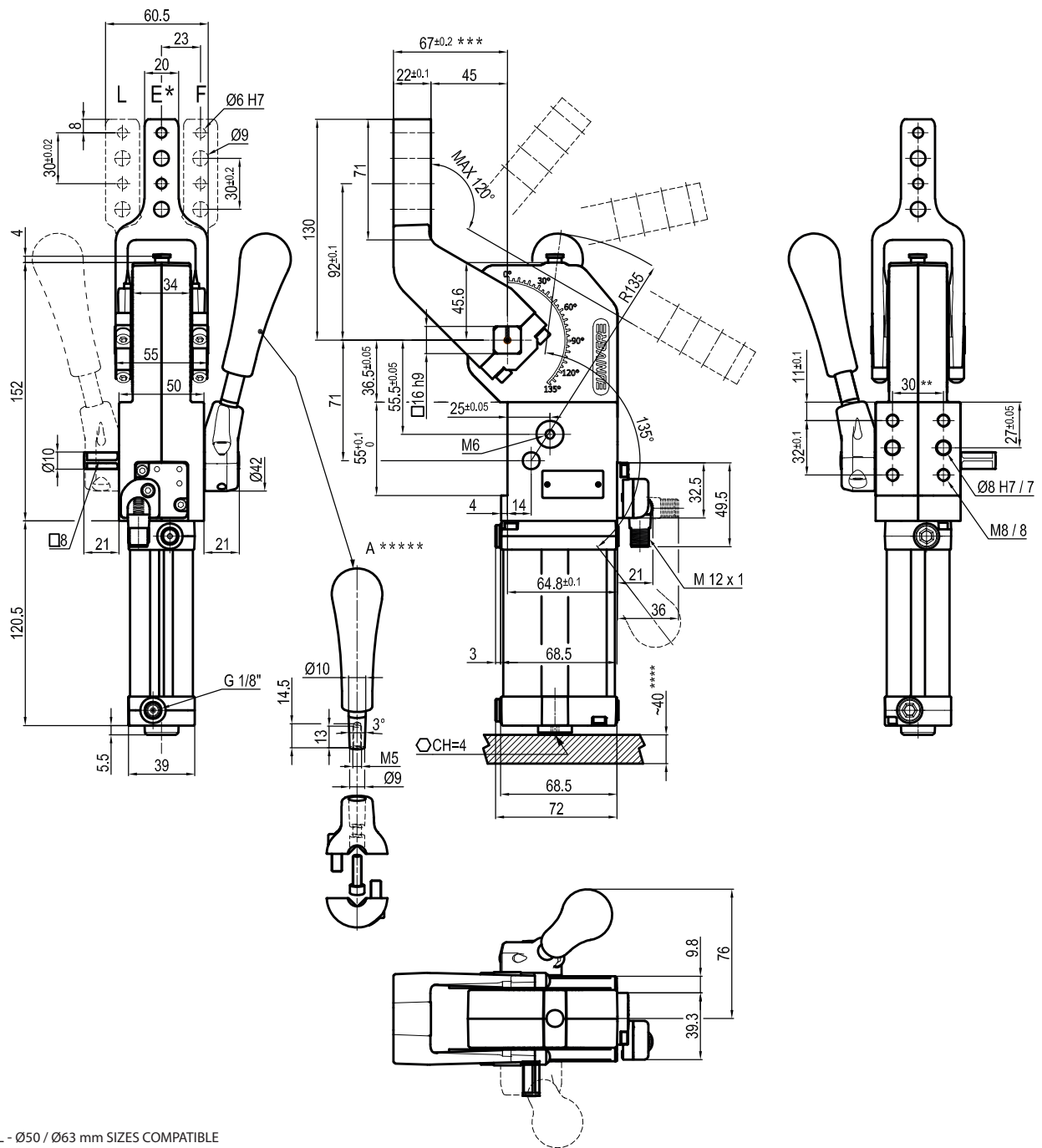

* : "E" CENTRAL - Ø50 / Ø63 mm SIZES COMPATIBLE
 ** : TOLERANCE BETWEEN DOWELS ± 0,02, BETWEEN SCREW HOLES ± 0,1
 *** : TOLERANCE AT 80 mm FROM PIVOT POINT
 **** : AREA TO ACCESS ANGLE ADJUSTMENT

UCIM400 __ AK0
6 ARM STYLE

7 ARM TYPE

6 7

 E = Central
 F = Right
 L = Left

 A = Aluminium
 S = Steel

Bore Ø	Holding moment	Clamping moment (0,5 MPa)	Weight (clamping arm not included)
40 mm	600 Nm	170 Nm	2,1 Kg

Min./Max. operating pressure: **0,4 / 0,6 MPa**
 Operating temperature: **5° ÷ 45° C**
 Opening angle: **adjustable from 0° to 120°**
 Arm position: **180°**
 With manual lever
 Electronic sensor with M12 swivel connector, from 0° to 90°
 Supply voltage: **10 ÷ 30 Vdc**
 IP code: **IP 65**
 Pneumatic ports on both sides

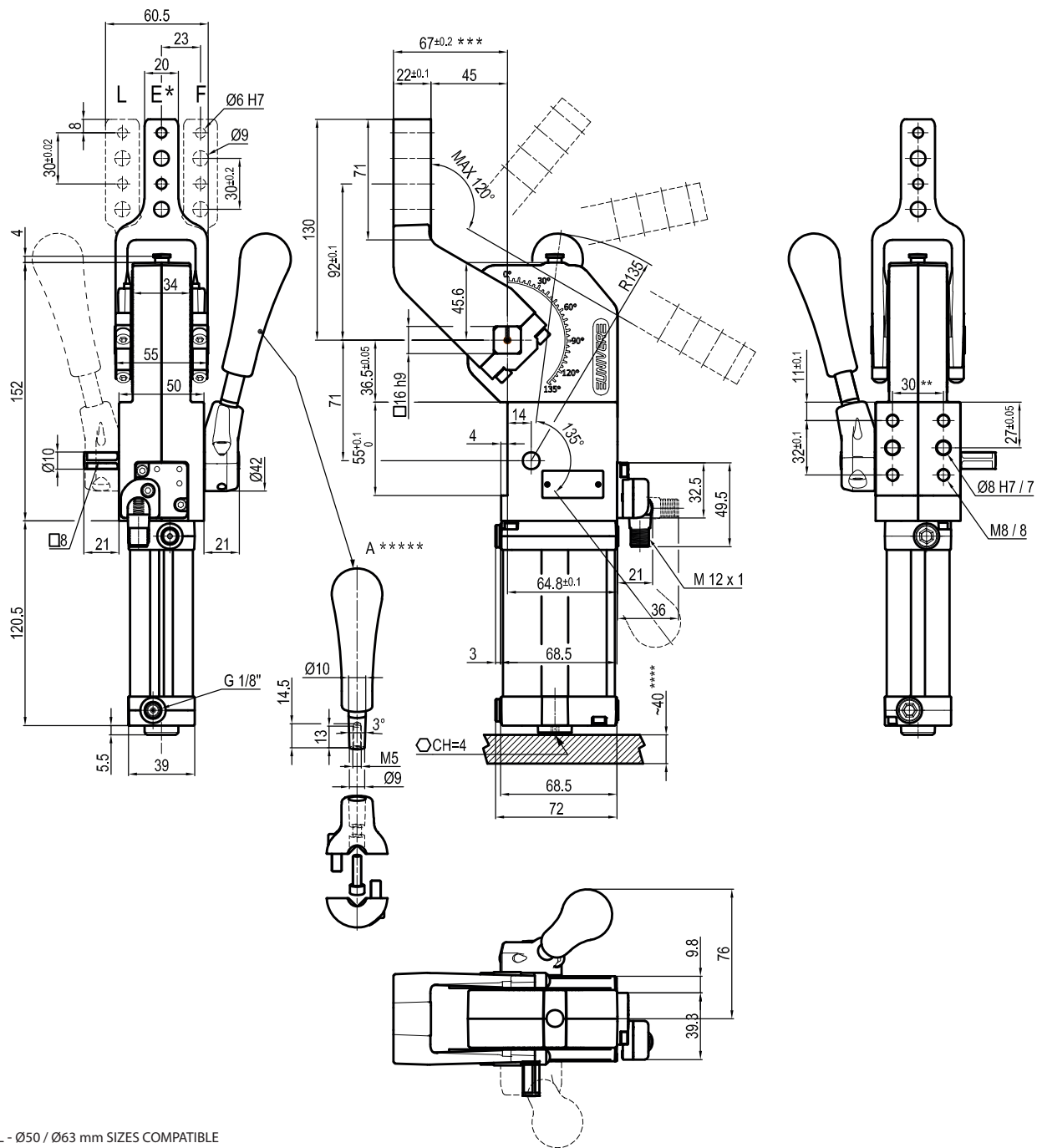

* : "E" CENTRAL - Ø50 / Ø63 mm SIZES COMPATIBLE
 ** : TOLERANCE BETWEEN DOWELS ± 0,02, BETWEEN SCREW HOLES ± 0,1
 *** : TOLERANCE AT 80 mm FROM PIVOT POINT
 **** : AREA TO ACCESS ANGLE ADJUSTMENT

UCIM400 __ NK0
6 7
6 ARM STYLE

7 ARM TYPE

E = Central
 F = Right
 L = Left

A = Aluminium
 S = Steel

Bore Ø	Holding moment	Clamping moment (0,5 MPa)	Weight (clamping arm not included)
40 mm	600 Nm	170 Nm	2,1 Kg

Min./Max. operating pressure: **0,4 / 0,6 MPa**
 Operating temperature: **5° ÷ 45° C**
 Opening angle: **adjustable from 0° to 120°**
 Arm position: **180°**
 With manual lever
 Electronic sensor with M12 swivel connector, from 0° to 90°
 Supply voltage: **10 ÷ 30 Vdc**
 IP code: **IP 65**
 Pneumatic ports on both sides

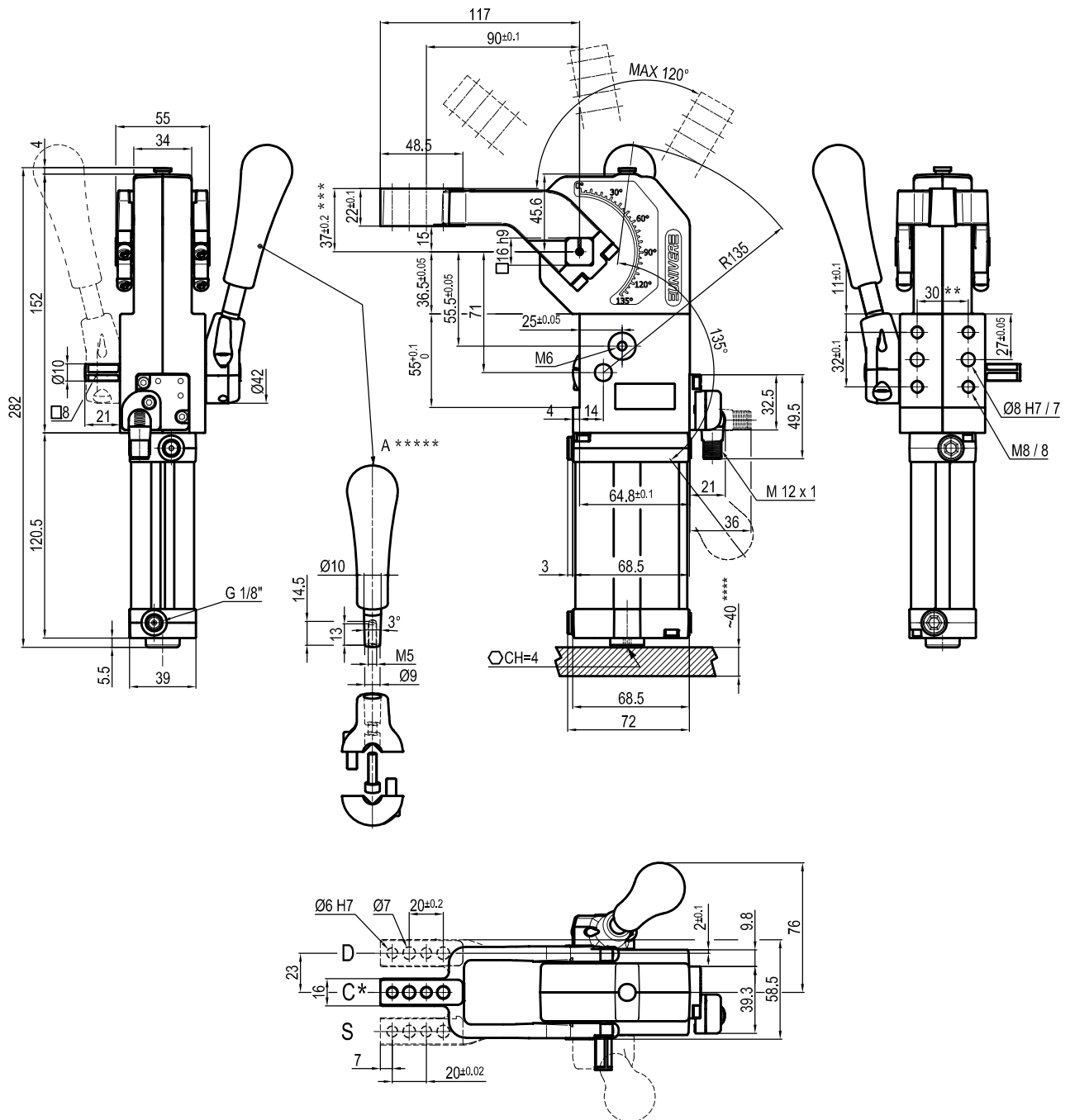

* : "E" CENTRAL - Ø50 / Ø63 mm SIZES COMPATIBLE
 ** : TOLERANCE BETWEEN DOWELS ± 0,02, BETWEEN SCREW HOLES ± 0,1
 *** : TOLERANCE AT 80 mm FROM PIVOT POINT
 **** : AREA TO ACCESS ANGLE ADJUSTMENT

UCIM40V__AK0
6 ARM STYLE

7 ARM TYPE

6 7

 C = Central
 D = Right
 S = Left

 A = Aluminium
 S = Steel

Bore Ø	Holding moment	Clamping moment (0,5 MPa)	Weight (clamping arm not included)
40 mm	600 Nm	170 Nm	2,1 Kg

Min./Max. operating pressure: **0,4 / 0,6 MPa**
 Operating temperature: **5° ÷ 45° C**
 Opening angle: **adjustable from 0° to 120°**
 Arm position: **90°**
 With hand lever
 Electronic sensor with M12 swivel connector, from 0° to 90°
 Supply voltage: **10 ÷ 30 Vdc**
 IP code: **IP 65**
 Pneumatic ports on both sides

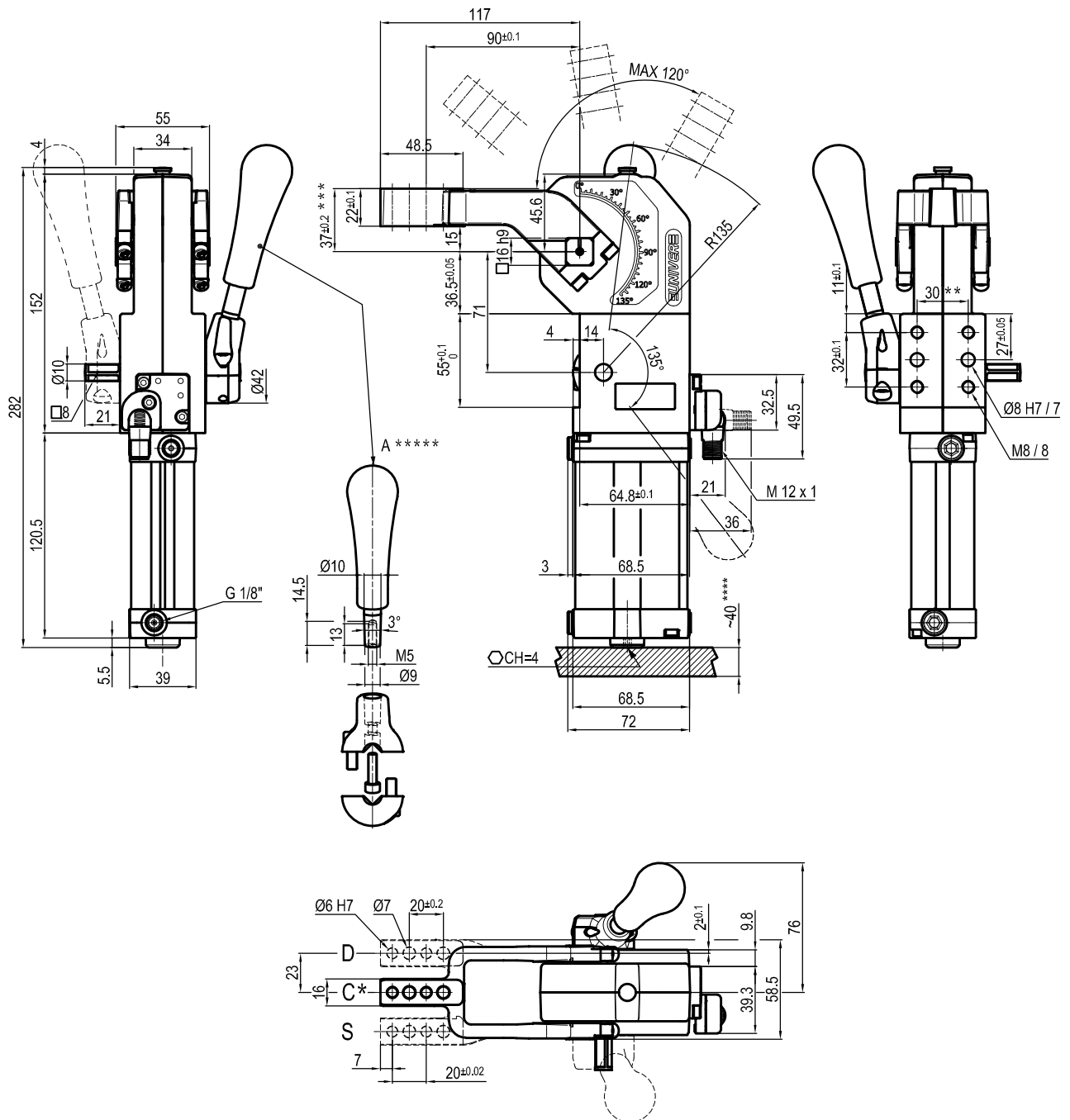

* : "E" CENTRAL - Ø50 / Ø63 mm SIZES COMPATIBLE
 ** : TOLERANCE BETWEEN DOWELS ± 0,02, BETWEEN SCREW HOLES ± 0,1
 *** : TOLERANCE AT 80 mm FROM PIVOT POINT
 **** : AREA TO ACCESS ANGLE ADJUSTMENT

UCIM40V __ NK0
6 ARM STYLE

7 ARM TYPE

6 7

 C = Central
 D = Right
 S = Left

 A = Aluminium
 S = Steel

Bore Ø	Holding moment	Clamping moment (0,5 MPa)	Weight (clamping arm not included)
40 mm	600 Nm	170 Nm	2,1 Kg

Min./Max. operating pressure: **0,4 / 0,6 MPa**
 Operating temperature: **5° ÷ 45° C**
 Opening angle: **adjustable from 0° to 120°**
 Arm position: **90°**
 With hand lever
 Electronic sensor with M12 swivel connector, from 0° to 90°
 Supply voltage: **10 ÷ 30 Vdc**
 IP code: **IP 65**
 Pneumatic ports on both sides

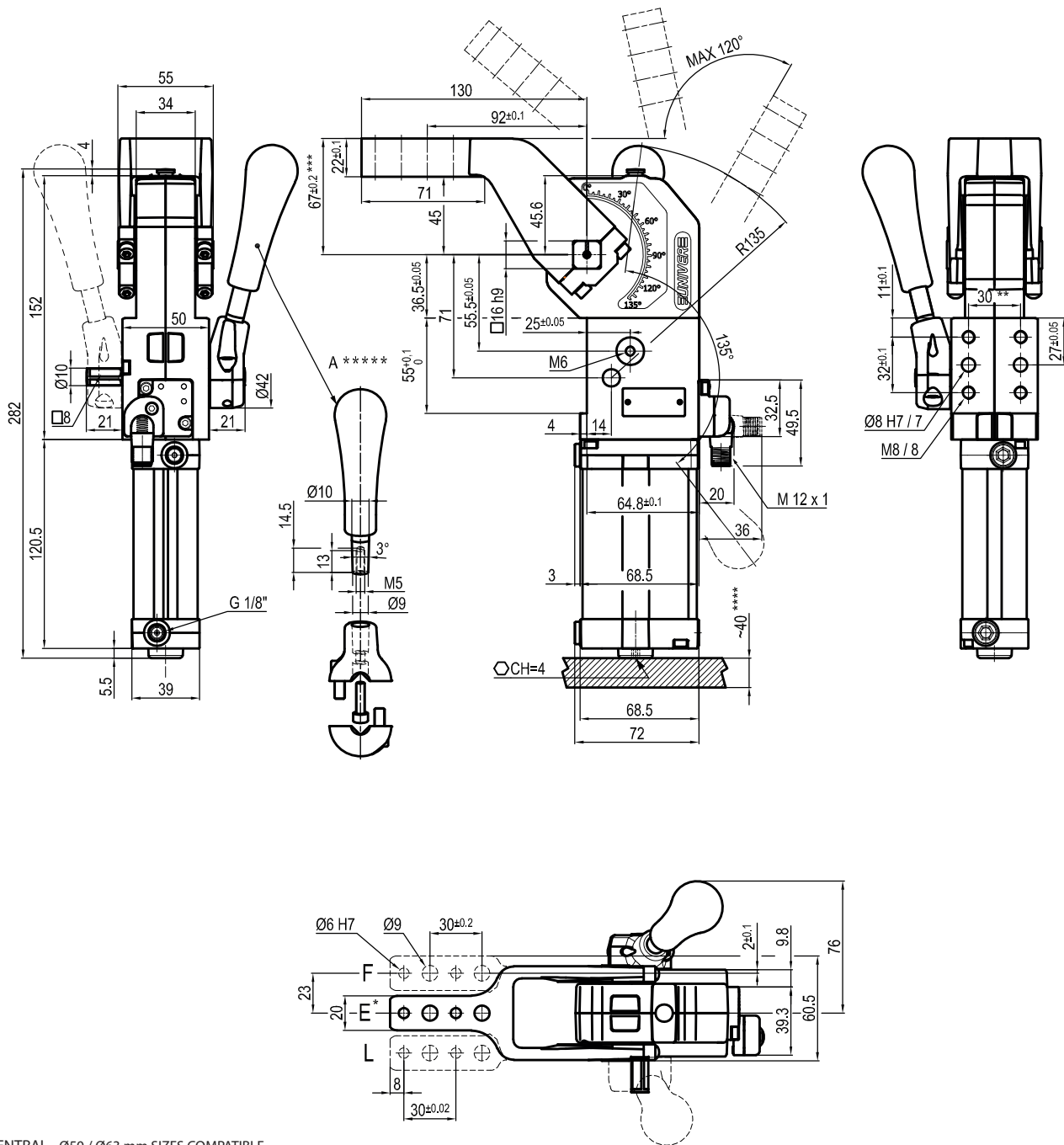

* : "E" CENTRAL - Ø50 / Ø63 mm SIZES COMPATIBLE
 ** : TOLERANCE BETWEEN DOWELS ± 0,02, BETWEEN SCREW HOLES ± 0,1
 *** : TOLERANCE AT 80 mm FROM PIVOT POINT
 **** : AREA TO ACCESS ANGLE ADJUSTMENT

UCIM40A __ NK0
6 7
6 ARM STYLE

E = Central
 F = Right
 L = Left

7 ARM TYPE

A = Aluminium
 S = Steel

Bore Ø	Holding moment	Clamping moment (0,5 MPa)	Weight (clamping arm not included)
40 mm	600 Nm	170 Nm	2,1 Kg

Min./Max. operating pressure: **0,4 / 0,6 MPa**
 Operating temperature: **5° ÷ 45° C**
 Opening angle: **adjustable from 0° to 120°**
 Arm position: **90°**
 With hand lever
 Electronic sensor with M12 swivel connector, from 0° to 90°
 Supply voltage: **10 ÷ 30 Vdc**
 IP code: **IP 65**
 Pneumatic ports on both sides

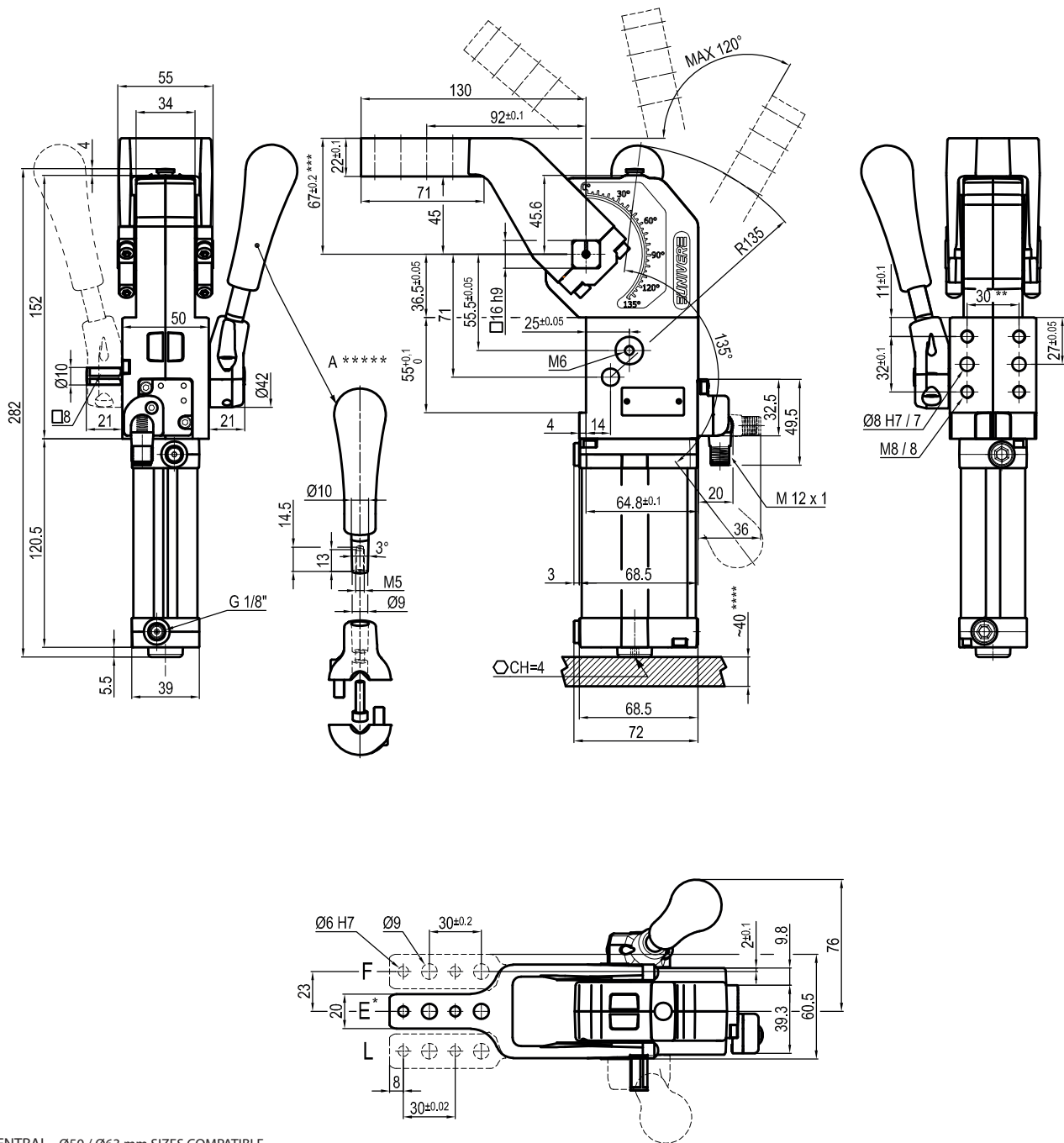

* : "E" CENTRAL - Ø50 / Ø63 mm SIZES COMPATIBLE
 ** : TOLERANCE BETWEEN DOWELS ± 0,02, BETWEEN SCREW HOLES ± 0,1
 *** : TOLERANCE AT 80 mm FROM PIVOT POINT
 **** : AREA TO ACCESS ANGLE ADJUSTMENT

UCIM40A __ NK0
6 ARM STYLE

7 ARM TYPE

6 7

E = Central
 F = Right
 L = Left

A = Aluminium
 S = Steel

Bore Ø	Holding moment	Clamping moment (0,5 MPa)	Weight (clamping arm not included)
40 mm	600 Nm	170 Nm	2,1 Kg

Min./Max. operating pressure: **0,4 / 0,6 MPa**
 Operating temperature: **5° ÷ 45° C**
 Opening angle: **adjustable from 0° to 120°**
 Arm position: **90°**
 With hand lever
 Electronic sensor with M12 swivel connector, from 0° to 90°
 Supply voltage: **10 ÷ 30 Vdc**
 IP code: **IP 65**
 Pneumatic ports on both sides