

# Oriental motor

ORIENTAL MOTOR U.S.A. Corp.  
570 Alaska Avenue  
Torrance, CA 90503  
1-800-GO-VEXTA (468-3982)

## Item # EH4-AZAKH, Electric Gripper



The EH Series is a electric gripper based on a rack-and-pinion mechanism equipped with an AZ Series motor. Its delicate grip, like that of a human hand, assists in automation and labor-saving.

- Requires AZ Series DC Input Driver
- Connection Cables sold separately

Web Price

**\$835.00**

## Specifications | Dimensions | Performance | System

### Specifications

<b>Lead Time<sup>1</sup></b>	Contact your local sales office for product lead-times, available to ship dates and shipping methods.
<b>Actuator Frame Size</b>	46 mm
<b>Input Power</b>	DC
<b>Maximum Grip Force</b>	25 N
<b>Repetitive Positioning Accuracy (mm)</b>	±0.02
<b>Backlash</b>	0.1 mm (each side)
<b>Stroke</b>	25 mm (12.5 mm each side)
<b>Maximum Speed</b>	156 mm/s (78 mm/s each side)
<b>Maximum Acceleration</b>	20 m/s <sup>2</sup> (10 m/s <sup>2</sup> each side)
<b>Push Speed</b>	20 mm/s (10 mm/s each side)

<b>Minimum Travel Amount</b>	0.02 mm (0.01 mm each side)
<b>Permissible Load</b>	5 N
<b>Static Permissible Moment Load</b>	$M_P$ : 1.2 N·m $M_Y$ : 0.12 N·m $M_R$ : 0.4 N·m
<b>Insulation Class</b>	Class B [130°C (266°F)]
<b>Insulation Resistance</b>	100 MΩ or more when 500 VDC megger is applied between the following places: Case - Motor and sensor windings
<b>Dielectric Strength</b>	Sufficient to withstand the following for 1 minute: Case - Motor and sensor windings 0.5 kVAC 50 Hz or 60 Hz
<b>Ambient Temperature</b>	0 ~ 40°C (32 ~ 104°F) (non-freezing)
<b>Ambient Humidity</b>	85% or less (Non-condensing)
<b>Operating Atmosphere</b>	Use in an area without corrosive gases and dust. The product should not be exposed to water, oil or other liquids.

## Dimensions

# Dimensions (Unit: mm)

2D & 3D CAD

Product Name	Mass kg	2D CAD
<b>EH4-AZAKH</b>	0.38	D7903

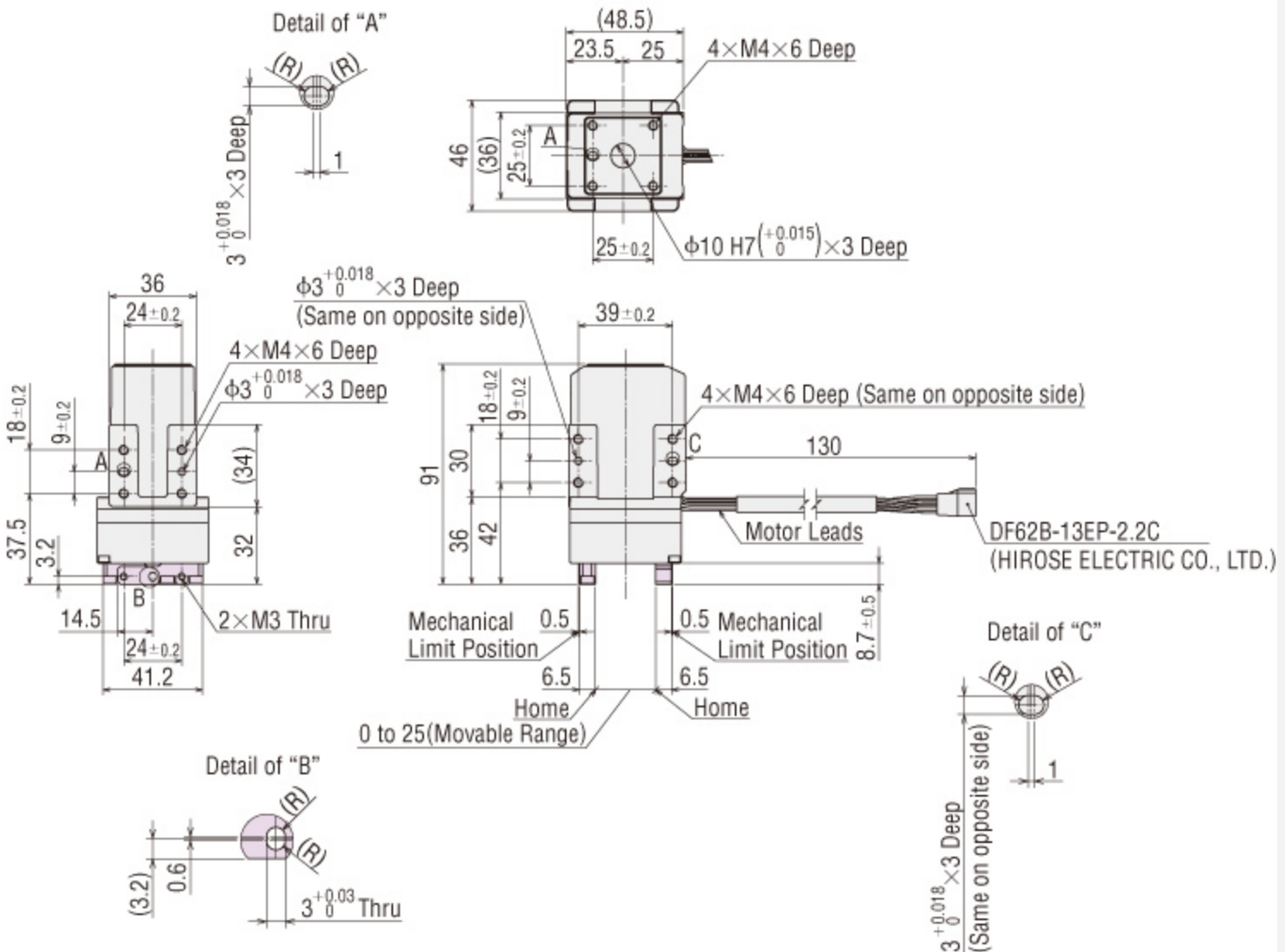

● The shaded areas are moving parts.

## Relationship between Push Force (Grip Force) and Current

The gripping movement of the electric gripper depends on the push-motion operation. The push force (grip force) is a current of the motor.

### Actual Push Force (Grip Force)

The push force (grip force) and current values are shown below as a reference. Check it on the actual assembled equipment.

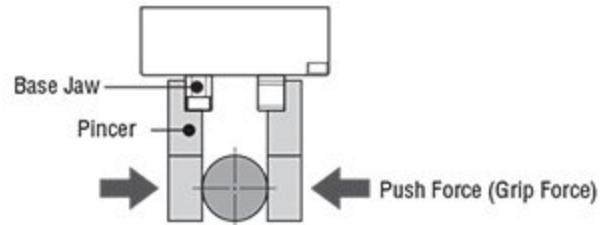
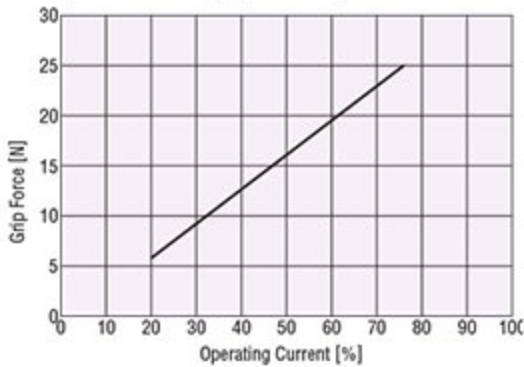

## Travel Direction

The default factory setting for direction of travel is as follows:

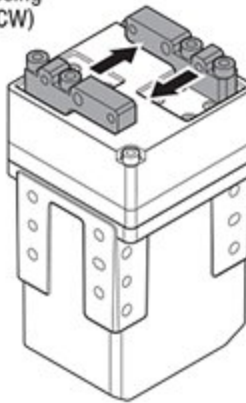
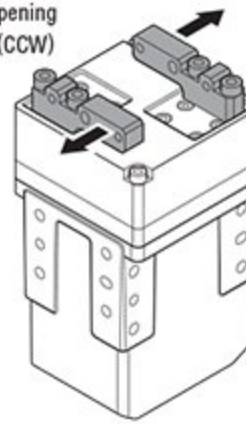
Travel Direction	Travel Direction
Base jaws closing +Direction (CW) 	Base jaws opening -Direction (CCW) 

# System Configuration

● Combination of Electric Gripper and Built-in Controller Type Driver, or Pulse Input Type Driver with An example of a configuration using I/O control or RS-485 communication is shown below.  
 Electric gripper, driver, and a connection cable/flexible connection cable are ordered separately.

● For a pulse input type driver system configuration, please see the Oriental Motor website.

- Required for operation
- Optional accessory

● Electric Gripper



● Connection Cable



● Extension cables used to lengthen connection cables and flexible cables used on moving parts are available in a variety of types and lengths.

● Driver



○ DC Power Supply Cable

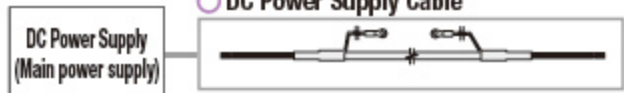

**Support Software MEXEO2**

● The MEXEO2 Data Setting Software can be downloaded from Oriental Motor Website.

Not supplied.  
 USB Cable

To connect to the host controller, three methods are available; I/O control, control via FA network or control via Modbus.

Host Controller

Network Converter



○ Cable for I/O Signals

I/O Control

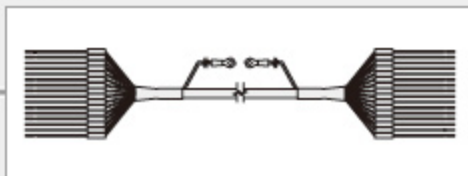

○ RS-485 Communication Cable

Control via FA Network

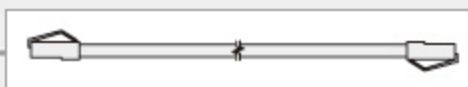

○ Cable for FLEX Communication

Control via Modbus



## System Configuration

### Combination of Electric Gripper and Network Compatible Driver

An example of a configuration using I/O control with an EtherNet/IP-compatible driver or EtherNet/IP is shown below. Electric gripper, driver, and a connection cable/flexible connection cable are ordered separately.

- Required for operation
- Optional accessory

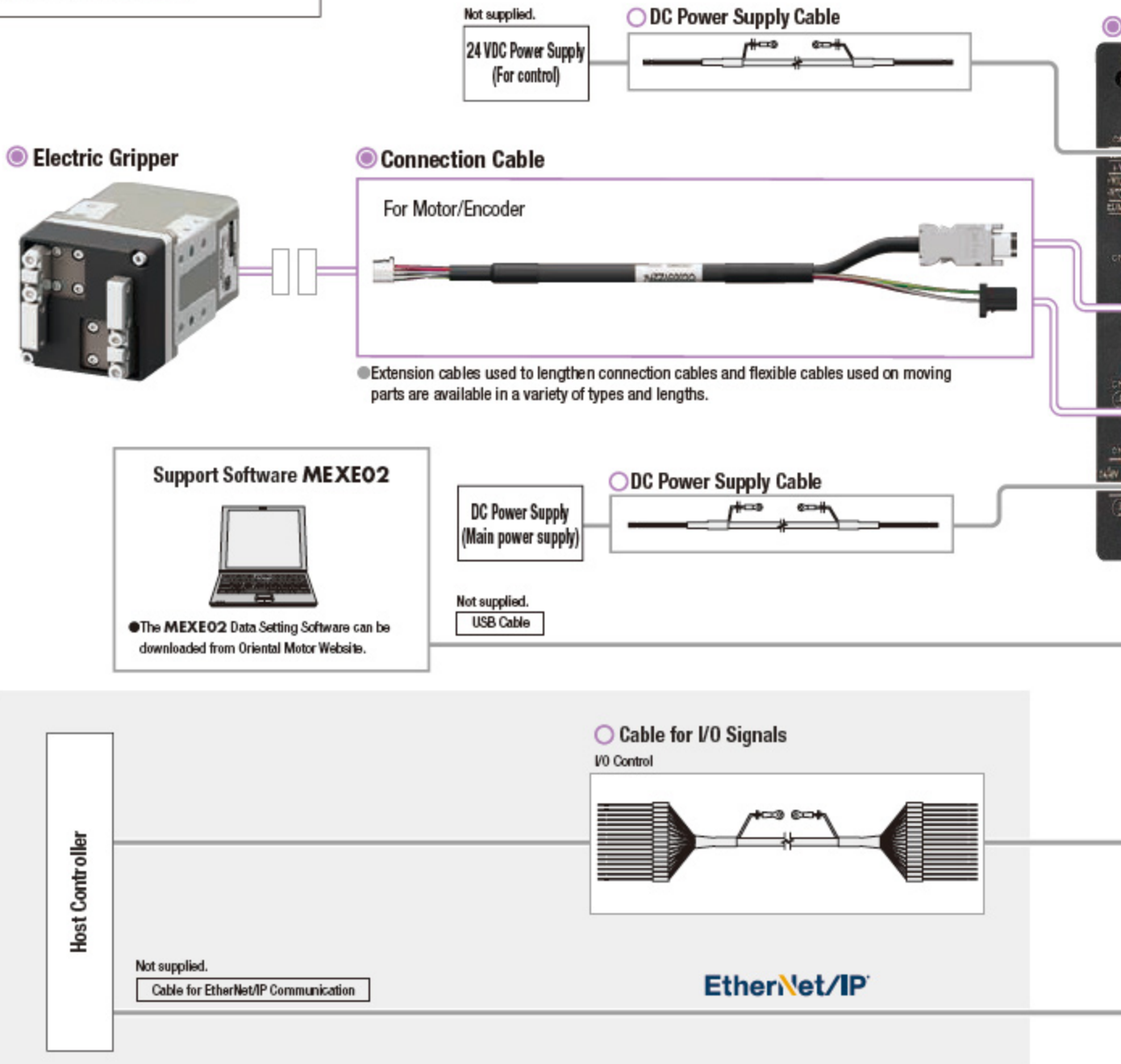

<sup>1</sup> Quoted Ship Date for orders placed before 12:00 pm PST. Quantities may affect Shipping Date.

Site Search...

