



ORIENTAL MOTOR U.S.A. Corp.
570 Alaska Avenue
Torrance, CA 90503
1-800-GO-VEXTA (468-3982)

Item # EH3-AZAKH, Electric Gripper



The EH Series is a electric gripper based on a rack-and-pinion mechanism equipped with an AZ Series motor. Its delicate grip, like that of a human hand, assists in automation and labor-saving.

- Requires AZ Series DC Input Driver
- Connection Cables sold separately

Web Price

\$835.00

[Specifications](#) | [Dimensions](#) | [Performance](#) | [System](#)

Specifications

Lead Time¹	Contact your local sales office for product lead-times, available to ship dates and shipping methods.
Actuator Frame Size	36 mm
Input Power	DC
Maximum Grip Force	7 N
Repetitive Positioning Accuracy (mm)	±0.02
Backlash	0.2 mm (each side)
Stroke	15 mm (7.5 mm each side)
Maximum Speed	156 mm/s (78 mm/s each side)
Maximum Acceleration	20 m/s ² (10 m/s ² each side)
Push Speed	20 mm/s (10 mm/s each side)

Minimum Travel Amount	0.02 mm (0.01 mm each side)
Permissible Load	2 N
Static Permissible Moment Load	M_P : 0.7 N·m M_Y : 0.2 N·m M_R : 0.2 N·m
Insulation Class	Class B [130°C (266°F)]
Insulation Resistance	100 MΩ or more when 500 VDC megger is applied between the following places: Case - Motor and sensor windings
Dielectric Strength	Sufficient to withstand the following for 1 minute: Case - Motor and sensor windings 0.5 kVAC 50 Hz or 60 Hz
Ambient Temperature	0 ~ 40°C (32 ~ 104°F) (non-freezing)
Ambient Humidity	85% or less (Non-condensing)
Operating Atmosphere	Use in an area without corrosive gases and dust. The product should not be exposed to water, oil or other liquids.

Dimensions

Dimensions (Unit: mm)

2D & 3D CAD

Product Name	Mass kg	2D CAD
EH3-AZAKH	0.2	D7908

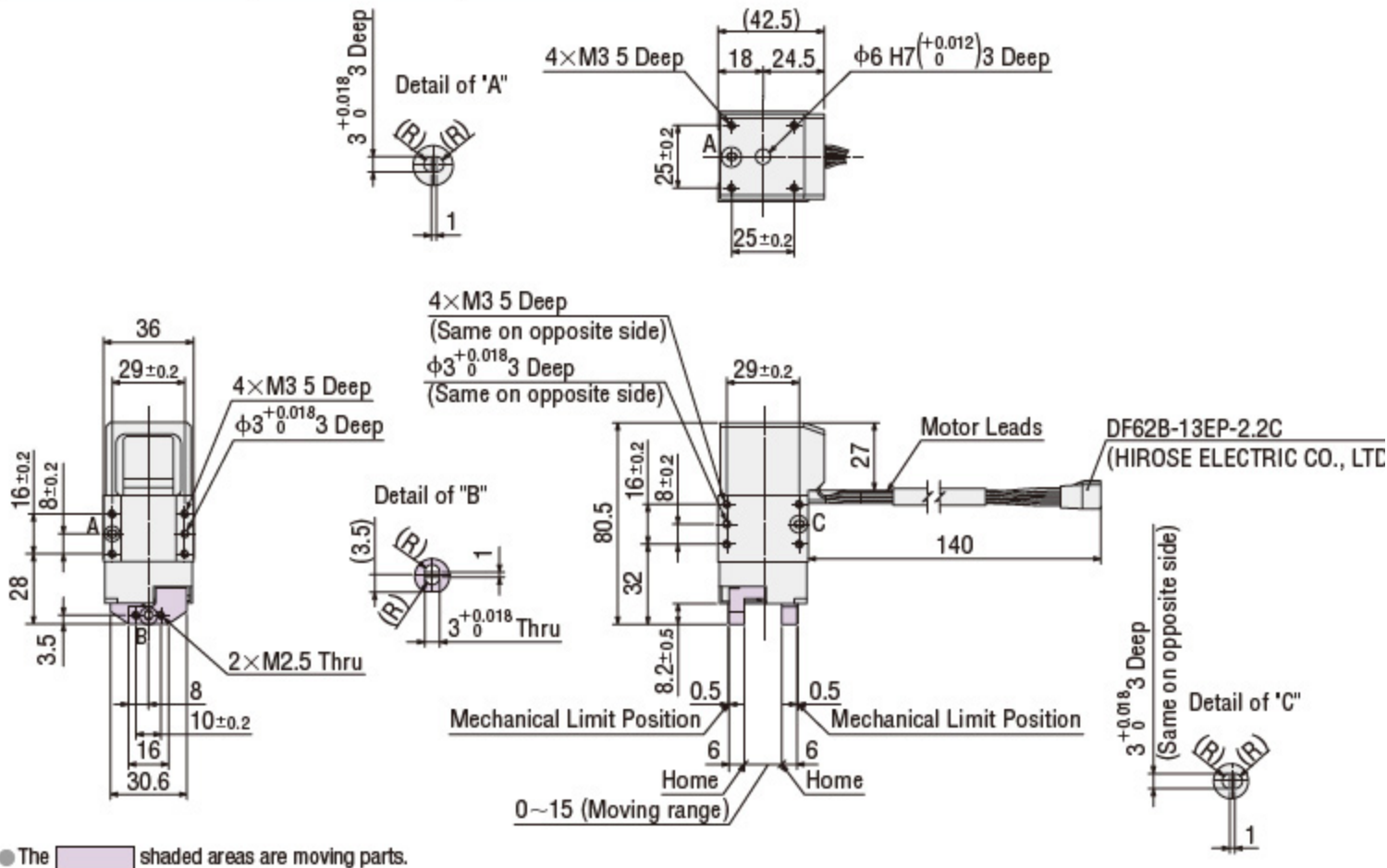

Relationship between Push Force (Grip Force) and Current

The gripping movement of the electric gripper depends on the push-motion operation.

The push force (grip force) is set by the operating current of the motor.

Actual Push Force (Grip force)

The push force (grip force) and current values are shown below as a reference.

Check it on the actual assembled equipment.

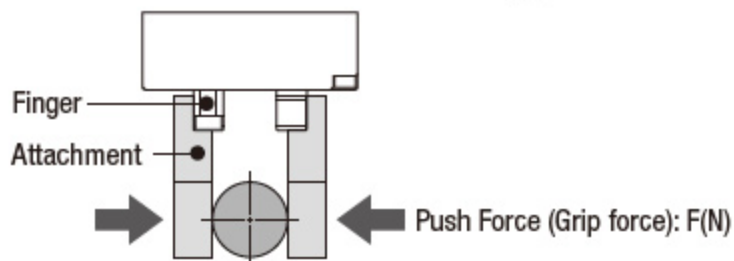

EH3-AZAKH

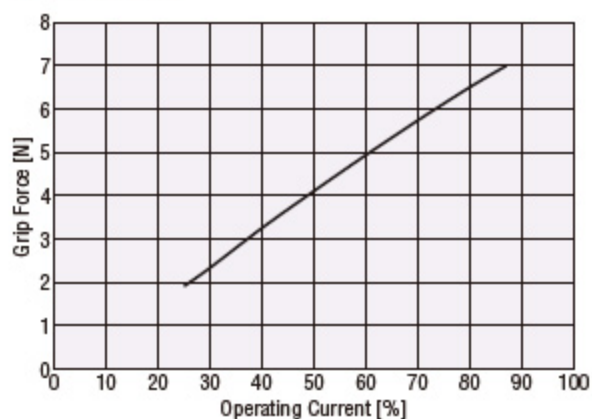

- Set the grip force during push-motion operation to 7 N or less.
- Set the operation speed during push-motion operation to 10 mm/s or less (single side).

Travel Direction

The default factory setting for direction of travel is as follows:

Travel Direction	Travel Direction
<p>Base jaws closing + Direction (CW)</p>	<p>Base jaws opening - Direction (CCW)</p>

--	--

System Configuration

● Combination of Electric Gripper and Built-in Controller Type Driver, or Pulse Input Type Driver with An example of a configuration using I/O control or RS-485 communication is shown below.

Electric gripper, driver, and a connection cable/flexible connection cable are ordered separately.

● For a pulse input type driver system configuration, please see the Oriental Motor website.

● Required for operation

○ Optional accessory

● Electric Gripper



● Connection Cable

For Motor/Encoder



● Extension cables used to lengthen connection cables and flexible cables used on moving parts are available in a variety of types and lengths.

○ DC Power Supply Cable

DC Power Supply
(Main power supply)

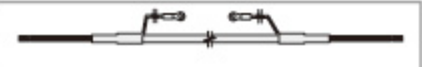

● Driver



Support Software **MEXE02**



● The **MEXE02** Data Setting Software can be downloaded from Oriental Motor Website.

Not supplied.
USB Cable

To connect to the host controller, three methods are available; I/O control, control via FA network or control via Modbus.

Host Controller

Network
Converter



○ Cable for I/O Signals

I/O Control



○ RS-485 Communication Cable

Control via FA Network



○ Cable for FLEX Communication

Control via Modbus



System Configuration

Combination of Electric Gripper and Network Compatible Driver

An example of a configuration using I/O control with an EtherNet/IP-compatible driver or EtherNet/IP is shown below. Electric gripper, driver, and a connection cable/flexible connection cable are ordered separately.

● Required for operation

○ Optional accessory

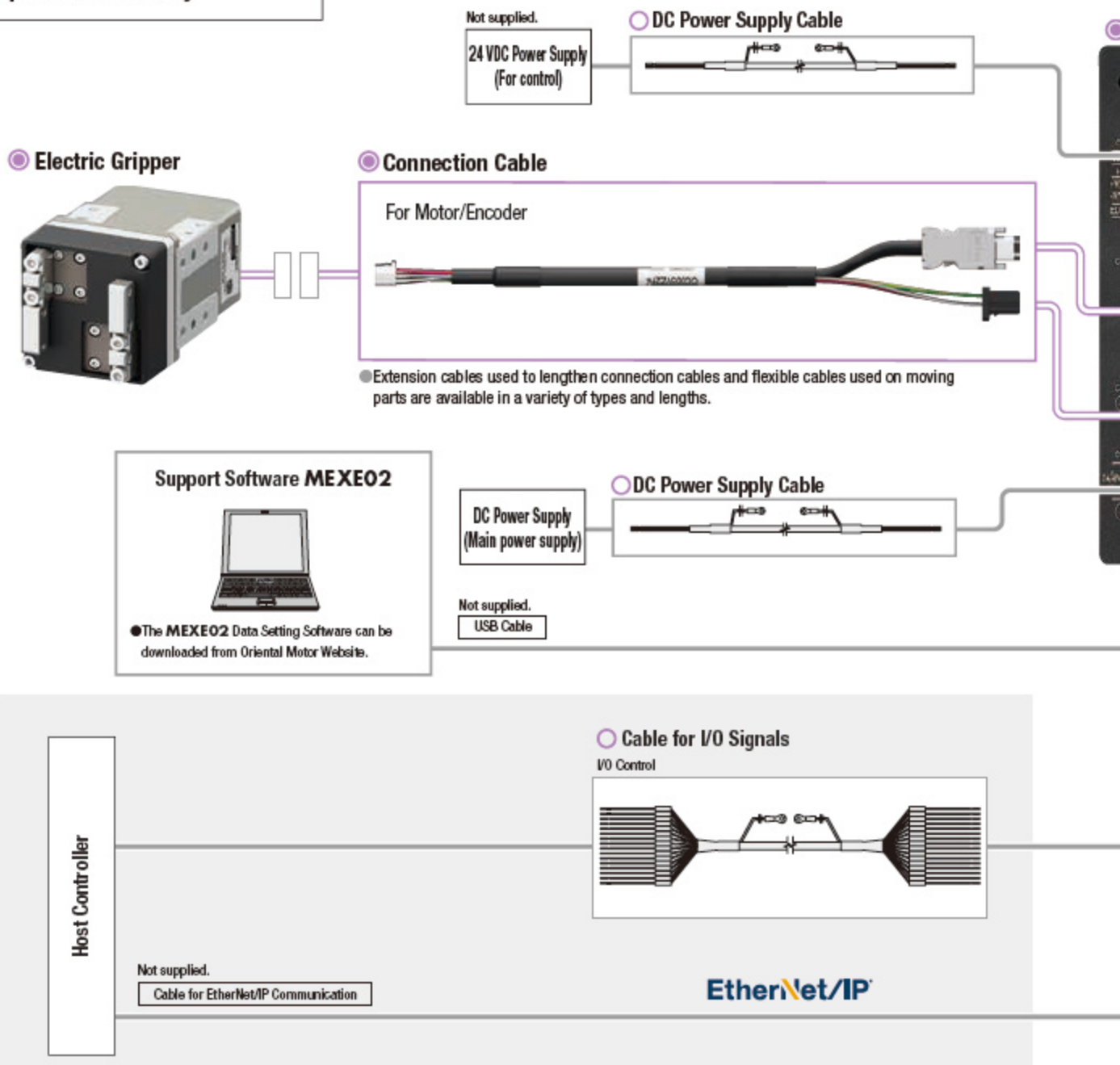

¹ Quoted Ship Date for orders placed before 12:00 pm PST. Quantities may affect Shipping Date.

Site Search...

