



Pictures might not correspond with technical data

Smoke Damper Actuator ANSK

ECONEX Smoke damper actuators of series ANSK are designed specifically for smoke application. During normal operation, the actuator motorized the damper when power on. In case of smoke emergency, the actuator motorised back to its original position when there is power on by outage or trip by thermal sensor.

TECHNICAL FEATURES

Torque	10 - 15 - 30 - 40 Nm	
Damper size	2 - 3 - 5 - 8 m ²	
Shaft dimensions	10 Nm	Form fit 12 mm square
	15 Nm	Form fit 12 mm square
	30 Nm	Form fit 12 mm square
	40 Nm	Form fit 12 mm square
Minimum shaft length	40 mm	
Actuator cable	1000 mm cable connection	
Power supply	AC/DC 24V ± 15% - 50-60 Hz	
	AC 230V ± 10% - 50-60 Hz	
Control signal	2 / 3 point (open-closed)	
Auxiliary switch rating	3(1.5) A, AC 250V (SPDT) 2 Fixed	
Power consumption operating and end position	10 Nm	3.0 W (1.0 W)
	15 Nm	5.0 W (1.0 W)
	30 Nm	6.0 W (1.0 W)
	40 Nm	6.5 W (1.0 W)
For wire sizing	10 Nm	7.0 VA
	15 Nm	10 VA
	30 Nm	10 VA
	40 Nm	10 VA
Protection class	III ⚡ 24V and II ⚡ 230V	

Angle of rotation	0°...90° (95° mechanical)	
Angle of limiting (mechanical)	45°...90° in 5° steps (adjustable)	
Weight	10 Nm	1.5 Kg
	15 Nm	1.5 Kg
	30 Nm	2.5 Kg
	40 Nm	2.5 Kg
Life cycle	60'000 rotation	
Sound level	M. 45 dB (A)	
IP protection	IP 54 (in vertical mounting)	
Operating temperature	-20°...+50° C / IEC 721-3-3	
Non-operating temperature	-40°...+70° C / IEC 721-3-2	
Ambient humidity	5%...95% rH non condensing EN 60730-1	
Maintenance	Maintenance free	
Mode of operation	Type I / EN 60730-1	
EMC	CE according to 2004 / 108/EC	
UL listing	UL 873	
Customer version	on request	
Thermal Sensor	72°C (optional)	
Manual override	to move open/closed	

MODELS

ANSK = Smoke damper actuator

Torque and running time

- 10Nm = 40s
- 15Nm = 40s
- 30Nm = 110s
- 40Nm = 110s

Power supply

- A = 24V AC/DC
- C = 230V AC 50-60 Hz

Auxiliary switches

- 2 = With n° 2 aux switches

Control signal

- S = Manual shaft release (On - Off version)

Optional

- TS = Thermal Sensor 72°C

ANSK

15

A

2

S

TS

Selected Example: ANSK15A2ST5

DIMENSIONS

10 Nm
15 Nm

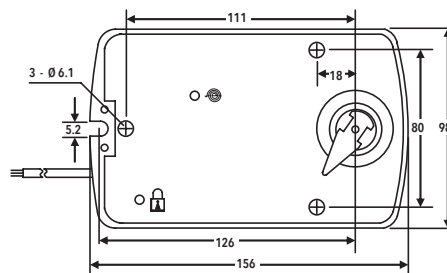
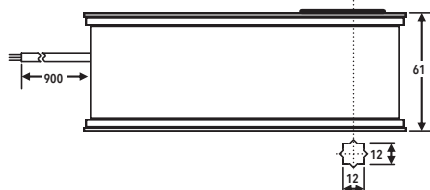

30 Nm
40 Nm

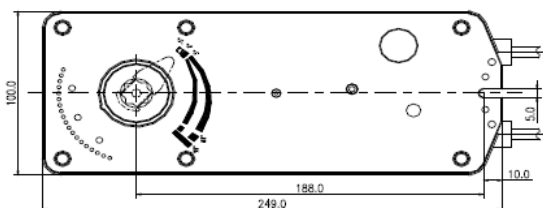
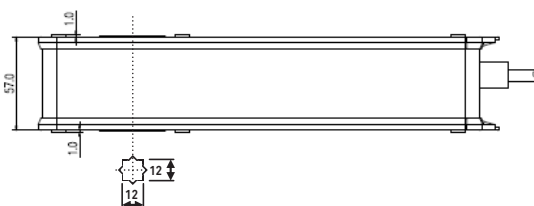

TS
Thermal
Sensor 72°C

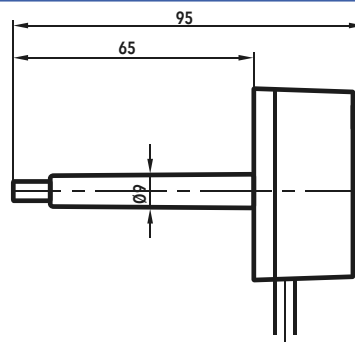
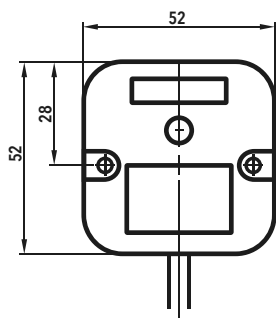

ROTATION ADJUSTMENT & AUXILIARY SWITCHES

CHANGING DIRECTION OF ROTATION

ANSK Actuator can be mounted in 2 direction, one CW, the other CCW.

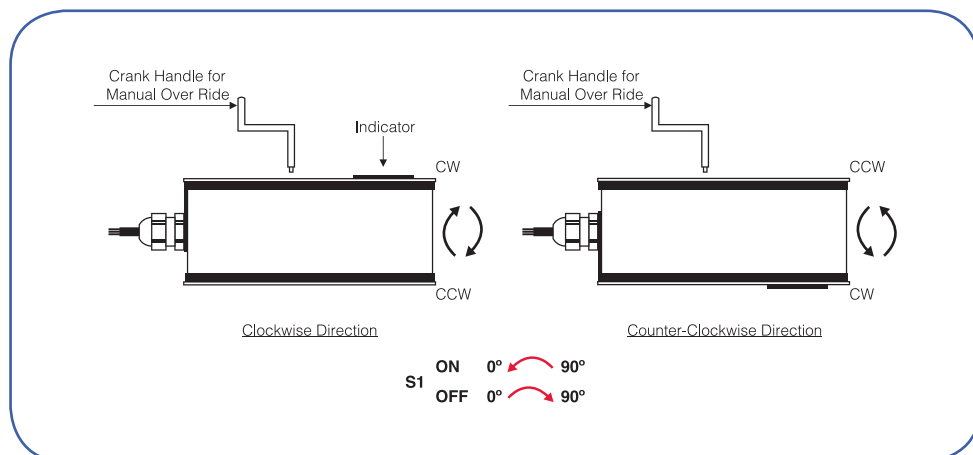

AUXILIARY SWITCHES ASRFS

The auxiliary switches for ANSK actuators are not adjustable. The switching points are fixed at 5° for switch **a** and at 85° for switch **b**.

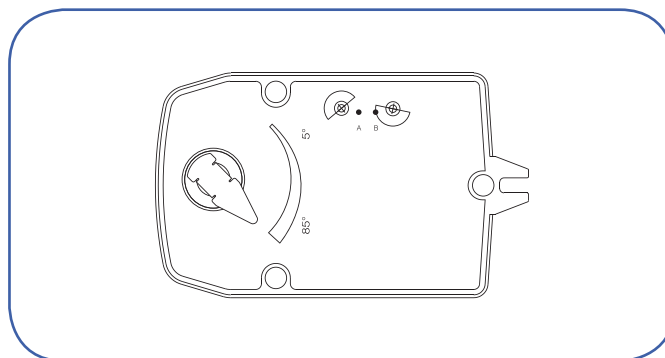

WIRING DIAGRAM

ON-OFF VERSION

Wiring diagram ANSK

Power supply AC/DC 24V

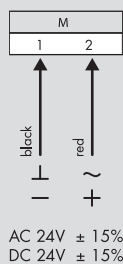

⚠ Connect via safety isolating transformer

Wiring diagram ANSK

Power supply AV 230V

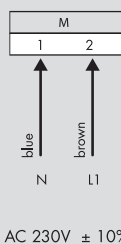

Wiring diagram auxiliary switches

ANSK

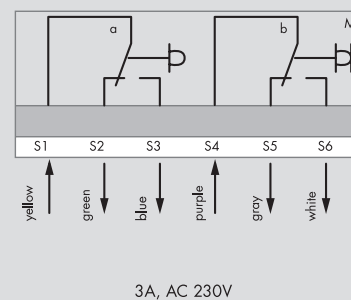

- The ANSK actuators are not allowed to be used outside the specified field of application as described at the front page of this data sheet.
- Only to be installed by skill educated persons. Any legal regulations or issued by authorities must be observed during installation.
- The ANSK actuator may only opened by ECONEX manufacturer site. Device does not contain any parts that can be replaced by user.
- The electrical connection cable must not be removed from the ANSK actuator.
- This actuator includes electrical and electronic components and may not be disposed as household garbage. Please consider the local valid legislation.
- AC 24V - 50/60 Hz - DC 24V: Connect via safety isolating transformer.
- AC 230V: To isolate from the main power supply, the system must incorporate a device which disconnects the phase conductor (with at least 3 mm contact gap).

IMPORTANT REMARKS

This actuator includes electrical and electronic components and may not be disposed as household garbage. Please consider the local valid legislation. 

AC/DC 24V: Connect via safety isolating transformer. AC 230V: To isolate from the main power supply, the system must incorporate a device which disconnects the phase conductor (with at least a 3 mm contact gap).

Consult ECONEX representatives for specific requirements and material selections for your intended application. The entire content of this technical datasheet is protected by copyright with all rights reserved ©.

The performance specifications are nominal and conform to acceptable industry standards. ECONEX shall not be liable for damages resulting from misapplication or misuse of its products.

CUSTOMISED VERSION

ECONEX offers you actuators in customised versions, e.g. with your own brand name, with colour-coordinated applications and with your particular demand on request.

Please contact us for further information.